

A.P. LOCK : SAPL-C SERIES

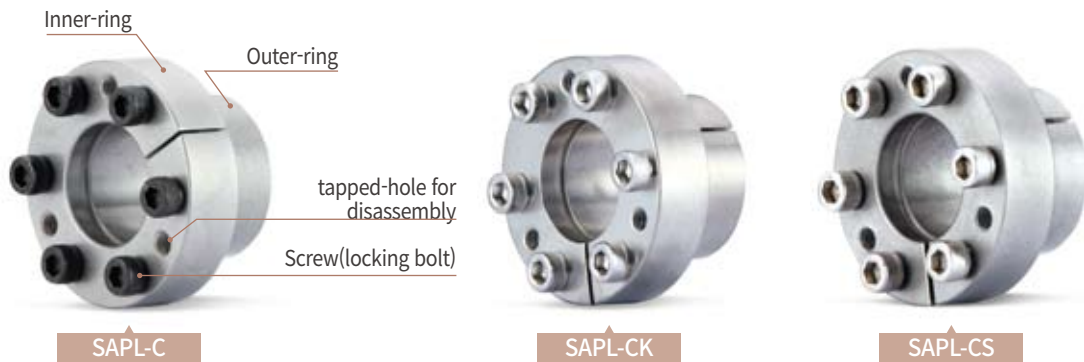

Structure and Material for SAPL-C Series

Model	Body (Inner-ring / Outer-ring)		Screw(locking bolt)	
	Material	Surface Treatment	Material	Surface Treatment
SAPL-C	STEEL	-	SCM435	Black Oxide
SAPL-CK	STEEL	Electroless Nickel Plating	SCM435	Electroless Nickel Plating
SAPL-CS	SUS304	-	SUSXM7	-

Product Features

- Self-centering function (prevention of slight off-center matters)
- Designed to suit smaller and shorter hubs (as there is only small difference in dimension between inner(d) and outer(D) diameters, as well as its surface pressure is low) – The most compact-designed series
- No movement while installed as the inner-ring is directly attached to hub surface
- Diverse material & finish options available (e.g. stainless steel body for vacuum area, electroless nickel plating etc.)

Principles

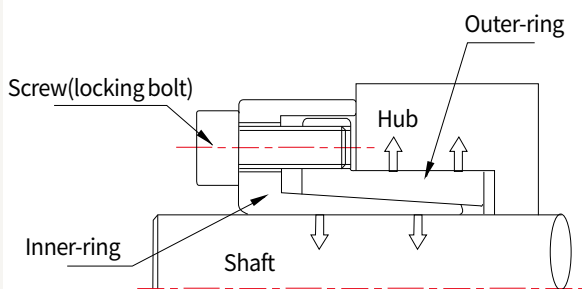

How to Order

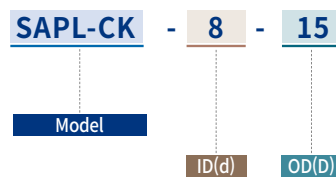

SAPL-C SERIES : SAPL-C



Dimensions / Performance

Model d x D	Size ($\pm 0.3\text{mm}$)					Max. Permissible Torque (Tc) (N·m)	Max. Permissible Thrust Load (Pt) (kN)	Surface Pressure (Mpa)		screw(locking bolt)			Mass(g)
	L ₁	L ₂	L	D ₁	P.C.D			Shaft(Pi)	Hub(Po)	Size	The no. of screws	Fastening Torque (N·m)	
SAPL-C-5 x 12	10	19	22	23	15.5	9	3.45	188	99	M3x8	4	1.7	36
SAPL-C-6 x 12	10	19	22	23	15.5	11	3.45	156	99	M3x8	4	1.7	34
SAPL-C-8 x 15	12	23	27	28	19.5	25	6.09	174	116	M4x10	4	4	61
SAPL-C-10 x 18	12	23	27	31.5	22.5	44	8.71	193	134	M4x10	5	4	78
SAPL-C-11 x 18	12	23	27	31.5	22.5	48	8.71	176	134	M4x10	5	4	75
SAPL-C-12 x 20	12	23	27	33.5	24.5	53	8.71	161	121	M4x10	5	4	86
SAPL-C-14 x 22	12	23	27	35.5	26.5	61	8.71	138	110	M4x10	5	4	94
SAPL-C-15 x 23	14	27	32	38.5	28.5	115	15.3	178	150	M5x12	4	8	135
SAPL-C-16 x 24	14	27	32	39.5	29.5	123	15.3	167	144	M5x12	4	8	140
SAPL-C-17 x 25	14	27	32	40.5	30.5	131	15.3	158	138	M5x12	4	8	146
SAPL-C-18 x 26	14	30	36	46	33	210	23.2	195	198	M6x14	4	14	221
SAPL-C-19 x 27	14	30	36	47	34	221	23.2	185	191	M6x14	4	14	228
SAPL-C-20 x 28	14	30	36	48	35	233	23.2	176	184	M6x14	4	14	235
SAPL-C-22 x 32	16	32	38	52	39	256	23.2	146	141	M6x14	4	14	287
SAPL-C-24 x 34	16	32	38	54	41	279	23.2	134	133	M6x14	4	14	302
SAPL-C-25 x 34	16	32	38	54	41	291	23.2	128	133	M6x14	4	14	293
SAPL-C-28 x 39	20	36	42	59	46	488	34.8	146	139	M6x14	6	14	378
SAPL-C-30 x 41	20	36	42	61	48	523	34.8	136	132	M6x14	6	14	396

- Pt(Max. Permissible Thrust Load) indicates values at the zero(0) torque, and Tc(Max. Permissible Torque) at the zero(0) thrust load respectively. In case torque and thrust load occur simultaneously, please refer to the formula in the [Selection guide] page for combined load calculation.
- For the best performance, make sure all foreign substances e.g. corrosion, dust etc. are removed from each surface of shaft, hub, and A.P. Lock's inner and outer ring.

SAPL-C SERIES : SAPL-CK

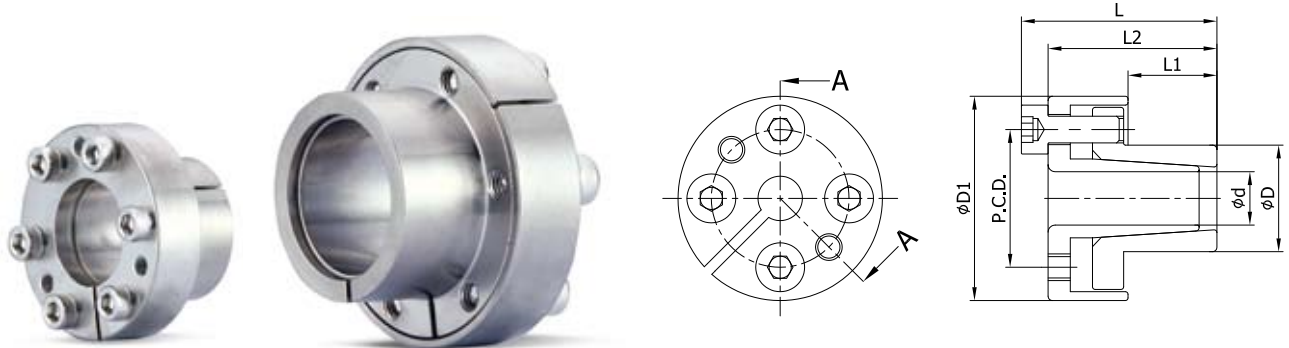

Dimensions / Performance

Model d x D	Size ($\pm 0.3\text{mm}$)					Max. Permissible Torque(Tc) (N·m)	Max. Permissible Thrust Load(Pt) (kN)	Surface Pressure (Mpa)		screw(locking bolt)			Mass(g)
	L ₁	L ₂	L	D ₁	P.C.D.			Shaft(Pi)	Hub(Po)	Size	The no. of screws	Fastening Torque(N·m)	
SAPL-CK-5 x 12	10	19	22	23	15.5	9	3.4	188	99	M3x8	4	1.7	36
SAPL-CK-6 x 12	10	19	22	23	15.5	11	3.4	156	99	M3x8	4	1.7	34
SAPL-CK-8 x 15	12	23	27	28	19.5	25	6	174	116	M4x10	4	4	61
SAPL-CK-10 x 18	12	23	27	31.5	22.5	44	8.7	193	134	M4x10	5	4	78
SAPL-CK-11 x 18	12	23	27	31.5	22.5	48	8.7	176	134	M4x10	5	4	75
SAPL-CK-12 x 20	12	23	27	33.5	24.5	53	8.7	161	121	M4x10	5	4	86
SAPL-CK-14 x 22	12	23	27	35.5	26.5	61	8.7	138	110	M4x10	5	4	94
SAPL-CK-15 x 23	14	27	32	38.5	28.5	115	15.3	178	150	M5x12	4	8	135
SAPL-CK-16 x 24	14	27	32	39.5	29.5	123	15.3	167	144	M5x12	4	8	140
SAPL-CK-17 x 25	14	27	32	40.5	30.5	131	15.3	158	138	M5x12	4	8	146
SAPL-CK-18 x 26	14	30	36	46	33	210	23.2	195	198	M6x14	4	14	221
SAPL-CK-19 x 27	14	30	36	47	34	221	23.2	185	191	M6x14	4	14	228
SAPL-CK-20 x 28	14	30	36	48	35	233	23.2	176	184	M6x14	4	14	235
SAPL-CK-22 x 32	16	32	38	52	39	256	23.2	146	141	M6x14	4	14	287
SAPL-CK-24 x 34	16	32	38	54	41	279	23.2	134	133	M6x14	4	14	302
SAPL-CK-25 x 34	16	32	38	54	41	291	23.2	128	133	M6x14	4	14	293
SAPL-CK-28 x 39	20	36	42	59	46	488	34.8	146	139	M6x14	6	14	378
SAPL-CK-30 x 41	20	36	42	61	48	523	34.8	136	132	M6x14	6	14	396

- Pt(Max. Permissible Thrust Load) indicates values at the zero(0) torque, and Tc(Max. Permissible Torque) at the zero(0) thrust load respectively. In case torque and thrust load occur simultaneously, please refer to the formula in the [Selection guide] page for combined load calculation.
- For the best performance, make sure all foreign substances e.g. corrosion, dust etc. are removed from each surface of shaft, hub, and A.P. Lock's inner and outer ring.

SAPL-C SERIES : SAPL-CS



Dimensions / Performance

Model d x D	Size ($\pm 0.3\text{mm}$)					Max. Permissible Torque(Tc) (N·m)	Max. Permissible Thrust Load(Pt) (kN)	Surface Pressure (Mpa)		screw(locking bolt)			Mass(g)
	L ₁	L ₂	L	D ₁	P.C.D			Shaft(Pi)	Hub(Po)	Size	The no. of screws	Fastening Torque(N·m)	
SAPL-CS-5 x 12	10	19	22	23	15.5	3	1.1	57	30	M3x8	4	1.1	36
SAPL-CS-6 x 12	10	19	22	23	15.5	4	1.1	48	30	M3x8	4	1.1	34
SAPL-CS-8 x 15	12	23	27	28	19.5	8	1.9	55	37	M4x10	4	2.7	61
SAPL-CS-10 x 18	12	23	27	31.5	22.5	14	2.7	61	43	M4x10	5	2.7	78
SAPL-CS-11 x 18	12	23	27	31.5	22.5	16	2.7	56	43	M4x10	5	2.7	75
SAPL-CS-12 x 20	12	23	27	33.5	24.5	17	2.7	51	39	M4x10	5	2.7	86
SAPL-CS-14 x 22	12	23	27	35.5	26.5	20	2.7	44	35	M4x10	5	2.7	94
SAPL-CS-15 x 23	14	27	32	38.5	28.5	38	5	59	49	M5x12	4	5.6	135
SAPL-CS-16 x 24	14	27	32	39.5	29.5	41	5	55	47	M5x12	4	5.6	140
SAPL-CS-17 x 25	14	27	32	40.5	30.5	43	5	52	46	M5x12	4	5.6	146
SAPL-CS-18 x 26	14	30	36	46	33	68	7.4	63	64	M6x14	4	9.6	221
SAPL-CS-19 x 27	14	30	36	47	34	71	7.4	60	62	M6x14	4	9.6	228
SAPL-CS-20 x 28	14	30	36	48	35	75	7.4	57	59	M6x14	4	9.6	235
SAPL-CS-22 x 32	16	32	38	52	39	83	7.4	47	46	M6x14	4	9.6	287
SAPL-CS-24 x 34	16	32	38	54	41	90	7.4	43	43	M6x14	4	9.6	302
SAPL-CS-25 x 34	16	32	38	54	41	94	7.4	42	43	M6x14	4	9.6	293
SAPL-CS-28 x 39	20	36	42	59	46	157	11.1	47	45	M6x14	6	9.6	378
SAPL-CS-30 x 41	20	36	42	61	48	168	11.1	44	43	M6x14	6	9.6	396

- Pt(Max. Permissible Thrust Load) indicates values at the zero(0) torque, and Tc(Max. Permissible Torque) at the zero(0) thrust load respectively. In case torque and thrust load occur simultaneously, please refer to the formula in the [Selection guide] page for combined load calculation.
- For the best performance, make sure all foreign substances e.g. corrosion, dust etc. are removed from each surface of shaft, hub, and A.P. Lock's inner and outer ring.